

# INTERNAL HALYARD PARTS & ACCESSORIES

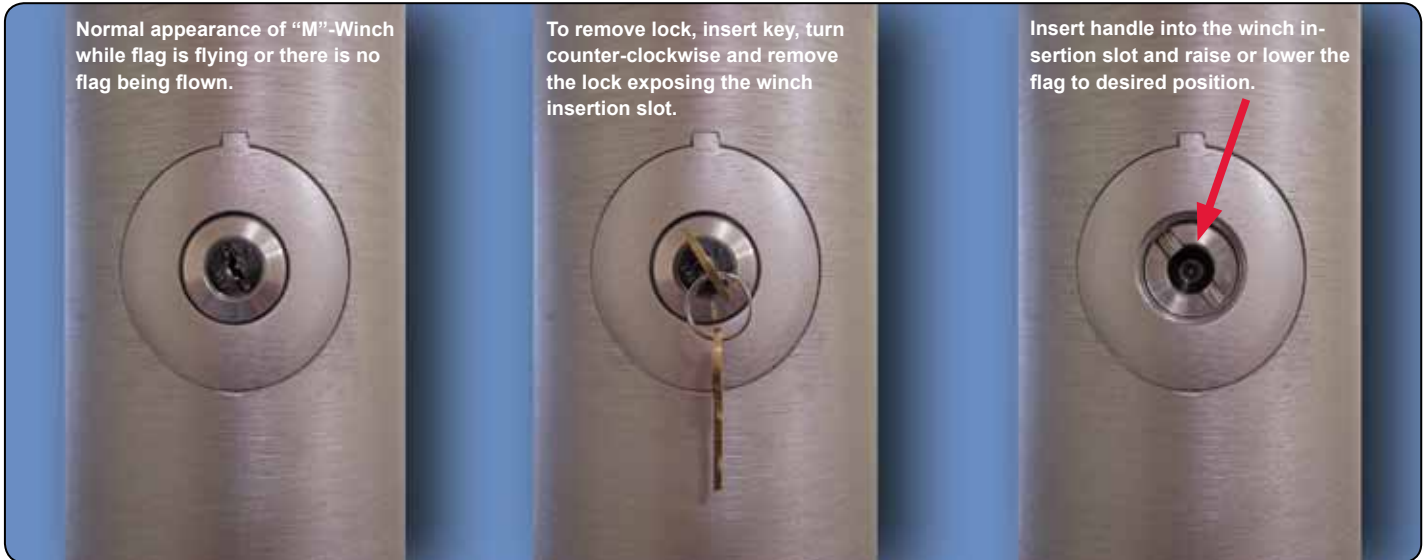

## "M" - WINCHES

The "M" - Winch is gearless and self locking at any point, eliminating the need for a separate break. This direct drive winch provides for rapid raising & lowering of the flag with little effort. This improved design does not require any welding thus avoiding discoloration when an anodized finish is required. No monthly lubrication is needed and this winch system is easily adaptable to existing on-site flagpoles. The winch is inserted into the pole and secured with a stainless steel bolt on the back side of the pole. Standard colors are Silver, Bronze #313, White & Black. Please specify color when ordering. If not specified Silver will be sent. Other sizes available upon request. The pricing below does not include a winch handle which is sold separately - see "M"-Winch Handle pricing below.



MODEL	FITS POLE DIA.	LBS.	SILVER			CLEAR			BRONZE #313			WHITE			BLACK		
			ITEM #	1-5	6+	ITEM #	1-5	6+	ITEM #	1-5	6+	ITEM #	1-5	6+	ITEM #	1-5	6+
M-5	5" w/.125 WALL	1.3	360000	\$440	\$420	360009	\$470	\$440	360018	\$470	\$440	360027	\$470	\$440	360036	\$470	\$440
M-5	5" w/.156 WALL	1.3	360344	440	420	360345	470	440	360346	470	440	360347	470	440	360348	470	440
M-6	6"	2.1	360001	690	630	360010	720	670	360019	720	670	360028	720	670	360037	720	670
M-7	7"	2.3	360002	690	630	360011	720	670	360020	720	670	360029	720	670	360038	720	670
M-8	8"	4.5	360003	780	700	360012	830	770	360021	830	770	360030	830	770	360039	830	770
M-10	10"	4.9	360004	830	770	360013	860	800	360022	860	800	360031	860	800	360040	860	800
M-1034	10 <sup>3/4</sup> "	5.1	360005	970	930	360014	950	880	360023	950	880	360032	950	880	360041	950	880
M-12	12" w/.250 WALL	5.0	360466	970	930	360467	950	880	360468	950	880	360469	950	880	360470	950	880
M-12	12" w/.375 WALL	5.0	360006	970	930	360015	950	880	360024	950	880	360033	950	880	360042	950	880
M-1234	12 <sup>3/4</sup> "	7.9	360007	1,930	1,800	360016	1,980	1,830	360025	1,980	1,830	360034	1,980	1,830	360043	1,980	1,830
M-14	14"	8.1	360008	1,930	1,800	360017	1,980	1,830	360026	1,980	1,830	360035	1,980	1,830	360044	1,980	1,830

"M"-Winches can be mixed to achieve the higher quantity pricing.

## "M" - WINCH HANDLES



## LOCKS & KEYS FOR "M" - WINCHES



MODEL	ITEM #	FOR "M"-WINCH MODEL #	1-5	6+	LBS.
MH-5	360045	M-5	\$54.00	\$49.00	.50
MH-612	360046	M-6 THRU M-14	113.00	105.00	1.1

All Winch Handles on this page can be mixed to achieve the higher quantity pricing.

MODEL	ITEM #	DESCRIPTION	1-5	6+	LBS.
M-L	360054	LOCK w/KEY	\$68.00	\$64.00	.08
M-K	360055	KEY ONLY*	9.70	9.20	.01

\*Please provide number located on cylinder lock when ordering replacement keys.

All bronze colored accessories on pages 162 through 186 are supplied in a dark bronze #313 shade. If medium bronze #312, light bronze #311 or a custom color is desired, please call for pricing.

# INTERNAL HALYARD PARTS & ACCESSORIES



## STAINLESS STEEL WINCHES

These winches are available for use on flagpoles with a butt diameter of 6" or larger. These gearless winches utilize cast bronze internal brakes which release when a winch handle is inserted and rotational pressure is applied. The winch is locked at any position by removing the handle which engages the brake system. The small size is generally used on flagpoles up to 45', the large size is used on flagpoles from 50' thru 80' and the X-Large size is used on flagpoles higher than 80'. The winch is mounted to the inside of the flagpole with two 5/16"-18NC stainless steel bolts with mounting centers being 3 1/2". Recommended diameters of stainless steel cable are 1/8" or 5/32".

MODEL	ITEM #	SIZE	MIN. POLE OPENING		DRUM WIDTH	1-5	6+	LBS.
			HEIGHT	WIDTH				
SSW1	360047	SMALL	3 1/8"	4 1/8"	1 1/2"	\$450	\$420	3.5
SSW2	360048	LARGE	3 5/8"	4 1/8"	2"	450	420	3.8
SSW3	360049	X-LARGE	6 5/8"	4 1/8"	5"	770	700	4.8

Stainless Steel Winches can be mixed to achieve the higher quantity pricing.

## HANDLE FOR STAINLESS STEEL WINCHES

This winch handle is designed to be used with any of the stainless steel winches described above.



MODEL	ITEM #	1-5	6+	LBS.
WH1	360051	\$43.00	\$41.00	1.3

All Winch Handles on this page can be mixed to achieve the higher quantity pricing.

## WINCH LUBRICANT

This silicone based aerosol spray is ideal to help keep stainless steel winches operating at peak performance ("M"-type winches do not require any lubrication).



ITEM #	1-5	6+	LBS.
360050	\$17.50	\$16.50	1.0

7.5 ounce

## CAM ACTION CLEATS

Used in rope style internal halyard flagpoles. The mounted version is secured onto a 1 1/2" x 3 3/8" aluminum block with two #10-32NC stainless steel pan head screws. Both versions are supplied with two #10-32NC stainless steel mounting screws. Recommended maximum rope diameter is 5/16".

ITEM #	DESCRIPTION	DISTANCE BETWEEN BOLT CENTERS			LBS.
			1-5	6+	
360052	MOUNTED	2 15/16"	\$33.00	\$29.00	.50
360053	UNMOUNTED	2"	19.50	18.50	.25



MOUNTED



UNMOUNTED

## STANDARD FLAG ARRANGEMENTS

Constructed of 1/8" stainless steel aircraft cable with a stainless steel thimble attached at each end with 2 copper crimps. These flag arrangements provide the method of attaching the flag or flags to the cable assembly. This is also an excellent method for changing the quantity of flags or the size(s) of flag(s) without having to change the entire cable assembly. Standard arrangements are supplied with either 2 or 3 stainless steel quick links depending on the recommended flag size. Deluxe arrangements are supplied with a more complete set of accessories.

MODEL	ITEM #	FOR FLAG SIZE	# OF QUICK LINKS	1-5	6+	LBS.
FA2	360079	2' x 3'	2	\$39	\$36	.50
FA25	360080	2 1/2' x 4'	2	42	39	.55
FA3	360081	3' x 5'	2	43	40	.55
FA4	360082	4' x 6'	2	45	42	.60
FA5	360083	5' x 8' or 5' x 9 1/2'	2	48	43	.65
FA6	360084	6' x 10'	2	52	48	.65
FA8	360085	8' x 12'	2	102	93	.70
FA10	360086	10' x 15' or 10' x 19'	3	105	95	.95
FA12	360087	12' x 18'	3	112	102	1.0
FA15	360088	15' x 25'	3	116	108	1.1
FA20	360089	20' x 30' or 20' x 38'	3	121	110	1.3
FA25	360090	25' x 40'	3	132	119	2.0
FA30	360091	30' x 50' or 30' x 60'	3	136	121	2.8

All Standard Flag Arrangements can be mixed to achieve the higher quantity pricing.

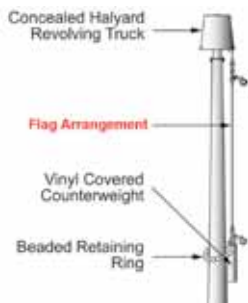

# INTERNAL HALYARD PARTS & ACCESSORIES

## DELUXE FLAG ARRANGEMENTS



Constructed of 1/8" stainless steel aircraft cable with a stainless steel thimble attached at each end with 2 copper crimps. These flag arrangements provide the method of attaching the flag or flags to the cable assembly. This is also an excellent method for changing the quantity of flags or the size(s) of flag(s) without having to change the entire cable assembly. Standard arrangements are supplied with either 2 or 3 stainless steel quick links depending on the recommended flag size. Deluxe arrangements are supplied with flag snaps, shock spring where needed and safety cable where needed.

MODEL	ITEM #	FOR FLAG SIZE	SUPPLIED WITH				1-5	6+	LBS.
			QUICK LINKS	FLAG SNAPS	SHOCK SPRING	SAFETY CABLE			
FA2	360474	2' x 3'	2	2 (BRASS ESSL)	----	----	\$44	\$41	1.2
FA25	360475	2 1/2' x 4'	2	2 (BRASS ESSL)	----	----	48	43	1.3
FA3	360476	3' x 5'	2	2 (BRASS ESSL)	----	----	49	44	1.3
FA4	360477	4' x 6'	2	2 (BRASS ESSL)	----	----	51	46	1.3
FA5	360478	5' x 8' or 5' x 9 1/2'	2	2 (BRASS ESSL)	----	----	54	49	1.4
FA6	360479	6' x 10'	2	2 (BRASS ESSL)	----	----	59	54	1.4
FA8	360480	8' x 12'	3	2 (STAINLESS STEEL SSFS-2)	1	1	114	102	2.3
FA10	360481	10' x 15' or 10' x 19'	3	2 (STAINLESS STEEL SSFS-2)	1	1	116	105	2.6
FA12	360482	12' x 18'	3	2 (STAINLESS STEEL SSFS-2)	1	1	124	112	2.6
FA15	360483	15' x 25'	3	2 (STAINLESS STEEL SSFS-2)	1	1	129	116	2.7
FA20	360484	20' x 30' or 20' x 38'	3	2 (STAINLESS STEEL SSFS-2)	1	1	135	121	2.9
FA25	360485	25' x 40'	3	2 (STAINLESS STEEL SSFS-2)	1	1	138	124	3.6
FA30	360486	30' x 50' or 30' x 60'	3	2 (STAINLESS STEEL SSFS-2)	1	1	141	126	4.4

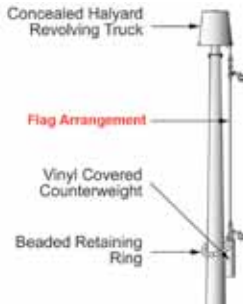

## CABLE ASSEMBLIES

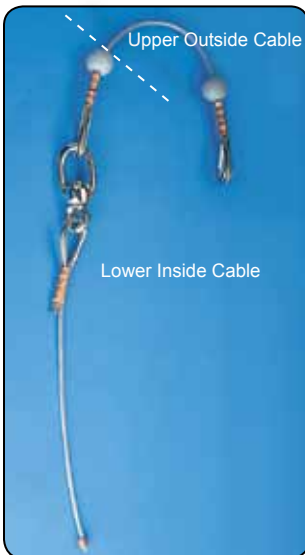

Constructed of 1/8" and/or 3/16" stainless steel aircraft cable incorporating a stainless steel swivel to minimize the effect of unraveling due to the rotation of the truck assembly. The lower cable section has a copper cable stop attached to one end for installation into a stainless steel winch. This cable stop can easily be removed if the winch is an "M"-type which does not require a cable stop. The upper cable section is supplied with a stainless steel thimble, 2 copper crimps, and two ball cable stops, however, because this section must be threaded through the truck assembly, these parts are not attached to the cable before shipment and must be attached in the field. These standard cable assemblies are designed for flagpoles with a winch installed at 5' above grade.

ITEM #	EXPOSED HT. OF FLAGPOLE	LOWER INSIDE CABLE		UPPER OUTSIDE CABLE		1-5	6+	LBS.
		DIA.	LEN.	DIA.	LEN.			
360056	20'	3/32"	20'	1/8"	20'	\$93	\$84	1.4
360332	25*	3/32"	25'	1/8"	25'	102	91	1.6
360057	25'	1/8"	25'	1/8"	25'	102	91	1.9
360333	30*	3/32"	30'	1/8"	30'	108	98	1.9
360058	30'	1/8"	30'	1/8"	30'	108	98	2.2
360334	35*	3/32"	35'	1/8"	35'	116	105	2.1
360059	35'	1/8"	35'	1/8"	35'	116	105	2.5
360060	40'	1/8"	40'	3/16"	40'	126	114	4.2
360061	45'	1/8"	45'	3/16"	45'	132	119	4.6
360062	50'	1/8"	50'	3/16"	50'	144	129	5.1
360063	60'	1/8"	60'	3/16"	60'	179	163	6.1
360064	70'	1/8"	70'	3/16"	70'	191	171	7.0
360065	78'	1/8"	78'	3/16"	78'	197	179	7.8
360066	80'	1/8"	80'	3/16"	80'	204	185	8.0
360067	90'	1/8"	90'	3/16"	90'	258	232	8.9
360068	100'	1/8"	100'	3/16"	100'	275	251	9.9
360069	110'	1/8"	110'	3/16"	110'	286	258	11
360070	120'	1/8"	120'	3/16"	120'	291	262	12
360071	130'	1/8"	130'	3/16"	130'	335	303	13
360072	140'	1/8"	140'	3/16"	140'	346	309	14
360073	150'	1/8"	150'	3/16"	150'	370	335	15
360074	160'	1/8"	160'	3/16"	160'	394	358	16
360075	170'	1/8"	170'	3/16"	170'	418	377	17
360076	180'	1/8"	180'	3/16"	180'	466	418	18
360077	190'	1/8"	190'	3/16"	190'	500	451	19
360078	200'	1/8"	200'	3/16"	200'	549	494	20

Cable Assemblies can be mixed to achieve higher quantity pricing.

\*To be used with 5" diameter poles with our M-5 Winch installed. Cable Assemblies can be mixed to achieve higher quantity pricing.

All bronze colored accessories on pages 162 through 186 are supplied in a dark bronze #313 shade. If medium bronze #312, light bronze #311 or a custom color is desired, please call for pricing.

# INTERNAL HALYARD PARTS & ACCESSORIES



## ROPE ASSEMBLIES

These assemblies are typically used in rope style internal halyard flagpoles where a cam cleat has been installed. Comes complete with a zinc plated carbon steel rope thimble attached to one end of the rope and stainless steel quick link.

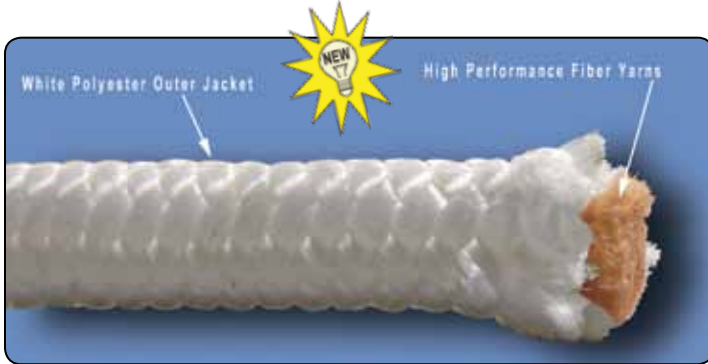

## TECHNORA® ROPE ASSEMBLIES

High performance - high tech fibers are encased inside a polyester fiber yarn jacket resulting in a high strength, low stretch, U.V. and abrasion resistant flagpole halyard.

HT. OF POLE	LEN. OF ROPE	DIA. OF ROPE	LBS..	WHITE		
				ITEM #	1-5	6+
20'	50'	1/4"	2.0	360495	\$64	\$58
25'	60'	1/4"	2.4	360496	78	70
30'	70'	1/4"	2.7	360497	91	83
35'	80'	1/4"	3.0	360498	102	92
40'	90'	1/4"	3.4	360499	116	105

## POLYPROPYLENE ROPE ASSEMBLIES - Can be mixed to achieve the higher quantity pricing

HT. OF POLE	LEN. OF ROPE	DIA. OF ROPE	LBS..	WHITE			SILVER			BRONZE #313			BLACK		
				ITEM #	1-5	6+	ITEM #	1-5	6+	ITEM #	1-5	6+	ITEM #	1-5	6+
20'	50'	1/4"	1.7	360096	\$20.00	\$17.50	360106	\$20.00	\$17.50	360116	\$20.00	\$17.50	360126	\$20.00	\$17.50
25'	60'	1/4"	2.1	360097	22.00	20.00	360107	23.00	21.00	360117	23.00	21.00	360127	23.00	21.00
30'	70'	1/4"	2.4	360098	24.00	22.00	360108	26.00	23.00	360118	26.00	23.00	360128	26.00	23.00
35'	80'	1/4"	2.7	360099	26.00	24.00	360109	27.00	25.00	360119	27.00	25.00	360129	27.00	25.00
40'	90'	1/4"	3.1	360100	29.00	26.00	360110	30.00	27.00	360120	30.00	27.00	360130	30.00	27.00

## NYLON WITH WIRE CENTER ROPE ASSEMBLIES - Can be mixed to achieve the higher quantity pricing

HT. OF POLE	LEN. OF ROPE	DIA. OF ROPE	LBS..	WHITE			SILVER			BRONZE #313			BLACK		
				ITEM #	1-5	6+	ITEM #	1-5	6+	ITEM #	1-5	6+	ITEM #	1-5	6+
20'	50'	3/16"	1.6	360137	\$30	\$28	360147	\$36	\$31	360157	\$36	\$31	360167	\$36	\$31
25'	60'	3/16"	1.9	360138	36	31	360148	42	39	360158	42	39	360168	42	39
30'	70'	3/16"	2.2	360139	40	37	360149	49	44	360159	49	44	360169	49	44
35'	80'	3/16"	2.5	360140	45	41	360150	57	52	360160	57	52	360170	57	52
40'	90'	3/16"	2.8	360340	65	50	360341	68	63	360342	68	63	360343	68	63

## ROPE RETAINER RINGS

Retainer rings are generally used with internal halyard flagpoles by providing a means of keeping the bottom of the flag close to the pole and as an aid to raise and lower the flag. Retainer rings can also be used on large multi-grommet flags on both external and internal halyard flagpoles as a means to keep the flags close to the pole and reduce the strain on the upper and lower grommets of the flag. These roped retainer rings are constructed of 3/16" nylon wire center halyard with a zinc plated carbon steel thimble attached to one end with an aluminum crimp. Complete with stainless steel quick link. Standard colors are White, Silver, Bronze #313 and Black. Please specify color when ordering. If not specified White will be supplied.



ALL SIZES

MODEL	BUTT DIA. OF POLE	LBS.	WHITE			SILVER			BRONZE #313			BLACK		
			ITEM #	1-5	6+	ITEM #	1-5	6+	ITEM #	1-5	6+	ITEM #	1-5	6+
RRR5	5"	.30	360230	\$17.50	\$15.50	360239	\$21.00	\$19.00	360248	\$21.00	\$19.00	360257	\$21.00	\$19.00
RRR6	6"	.30	360231	19.00	16.50	360240	22.00	20.00	360249	22.00	20.00	360258	22.00	20.00
RRR65	6 1/2"	.30	360232	20.00	17.50	360241	23.00	21.00	360250	23.00	21.00	360259	23.00	21.00
RRR7	7"	.32	360233	21.00	19.00	360242	25.00	23.00	360251	25.00	23.00	360260	25.00	23.00
RRR8	8"	.32	360234	22.00	20.00	360243	26.00	24.00	360252	26.00	24.00	360261	26.00	24.00
RRR10	10"	.34	360235	23.00	21.00	360244	27.00	25.00	360253	27.00	25.00	360262	27.00	25.00
RRR105	10 1/2"	.34	360236	26.00	24.00	360245	33.00	29.00	360254	33.00	29.00	360263	33.00	29.00
RRR115	11 1/2"	.36	360237	29.00	25.00	360246	37.00	33.00	360255	37.00	33.00	360264	37.00	33.00
RRR12	12"	.36	360238	31.00	27.00	360247	39.00	36.00	360256	39.00	36.00	360265	39.00	36.00
RRR16	16"	.50	360349	41.00	38.00	----	----	----	360350	50.00	45.00	----	----	----
RRR163	16 3/4"	.50	360351	50.00	45.00	----	----	----	360352	50.00	45.00	----	----	----

Rope Retainer Rings can be mixed to achieve the higher quantity pricing.

# INTERNAL HALYARD PARTS & ACCESSORIES

## BEADED RETAINER RINGS

Retainer rings are generally used with internal halyard flagpoles by providing a means of keeping the bottom of the flag close to the pole and as an aid to raise and lower the flag. Retainer rings can also be used on large multi-grommet flags on both external and internal halyard flagpoles as a means to keep the flags close to the pole and reduce the strain on the upper and lower grommets of the flag. These beaded rings are constructed of either 1" or combination of 1" & 2" diameter nylon balls strung onto 1/8" stainless steel aircraft cable with a stainless steel thimble attached to each end with two copper crimps. Complete with stainless steel quick link. Standard stock colors are White, Silver and Bronze #313. Please specify color when ordering. If not specified White will be supplied. The length of each retainer ring was determined by measuring from the outside tip of each thimble (the quick link was not included in the measurement).

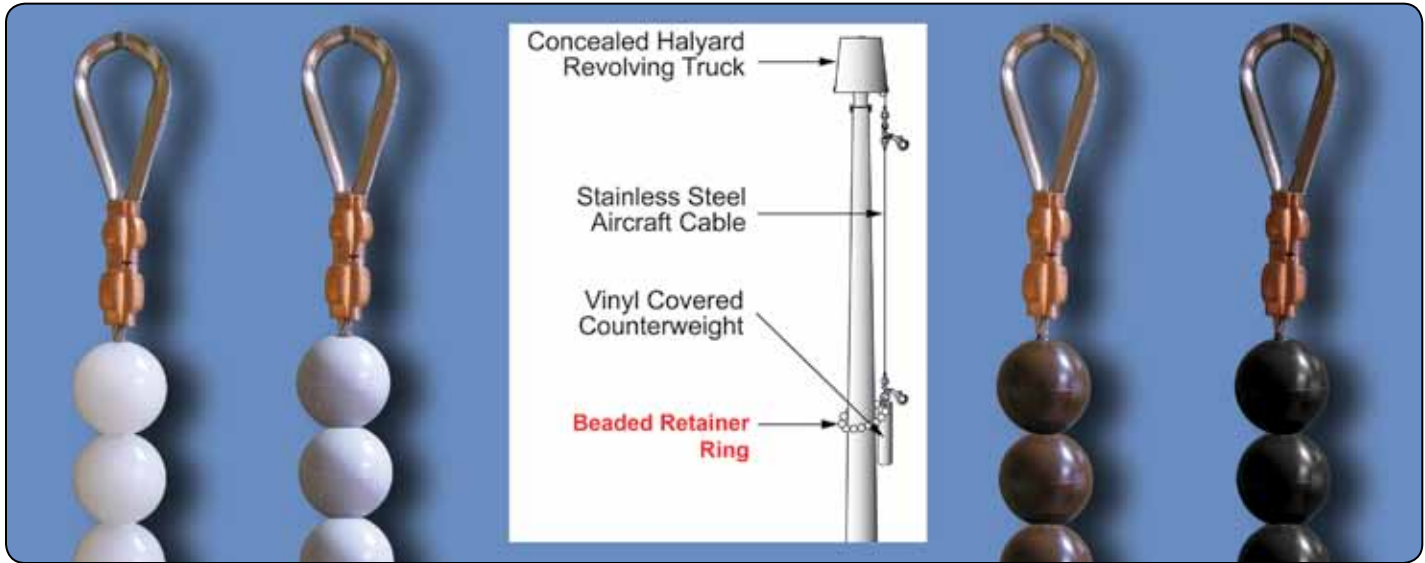

MODEL	LENGTH	BUTT DIA. OF POLE	DIA. OF BALLS	LBS.	WHITE			SILVER			BRONZE #313			BLACK		
					ITEM #	1-5	6+	ITEM #	1-5	6+	ITEM #	1-5	6+	ITEM #	1-5	6+
RR5	30"	5"	1"	.75	360176	\$41	\$38	360194	\$48	\$43	360212	\$48	\$43	360488	\$48	\$43
RR6	34"	6"	1"	.80	360177	42	39	360195	50	45	360213	50	45	360489	50	45
RR7	38"	7"	1"	.85	360178	44	41	360196	52	48	360214	52	48	360490	52	48
RR8	42"	8"	1"	.90	360179	45	42	360197	54	49	360215	54	49	360491	54	49
RR10	50"	10"	1"	1.1	360180	50	45	360198	55	50	360216	55	50	360492	55	50
RR11	54"	11"	1"	1.2	360181	54	48	360199	60	55	360217	60	55	360493	60	55
RR12	58"	12"	1"	1.2	360182	55	50	360200	62	57	360218	62	57	360494	62	57
RR13	62"	13"	1" & 2"	2.5	360183	102	93									
RR14	66"	14"	1" & 2"	2.7	360184	108	98									
RR16	74"	16"	1" & 2"	3.1	360185	124	112									
RR18	82"	18"	1" & 2"	3.4	360186	141	129									
RR20	90"	20"	1" & 2"	3.8	360187	155	141									
RR22	98"	22"	1" & 2"	4.2	360188	171	155									
RR24	106"	24"	1" & 2"	4.6	360189	189	171									
RR30	124"	30"	1" & 2"	5.8	360190	223	204									
RR32	132"	32"	1" & 2"	6.2	360191	239	214									
RR34	140"	34"	1" & 2"	6.6	360192	262	239									
RR36	148"	36"	1" & 2"	7.0	360193	275	251									

Beaded Retainer Rings can be mixed to achieve the higher quantity pricing.



## NYLON RETAINER RING BALLS

Drilled to be strung onto 1/8" stainless steel aircraft cable.

ITEM #	DIA. OF BALL	COLOR OF BALL	1-99	100+	LBS.
360266	1"	WHITE	\$0.64	\$0.56	.02
360267	1"	SILVER	0.72	0.66	.02
360268	1"	BRONZE	0.72	0.66	.02
360487	1"	BLACK	0.72	0.66	.02
360269	1 1/2"	WHITE	2.80	2.60	.06
360270	2"	WHITE	4.30	3.90	.15

All bronze colored accessories on pages 162 through 186 are supplied in a dark bronze #313 shade. If medium bronze #312, light bronze #311 or a custom color is desired, please call for pricing.

# INTERNAL HALYARD PARTS & ACCESSORIES

## INTERNAL HALYARD DOORS FOR ALUMINUM FLAGPOLES

With Lock & Keys



6"



7" Through 12"

MODEL	POLE DIA.	LBS.	SILVER			CLEAR			BRONZE #313			WHITE			BLACK		
			ITEM #	1-5	6+	ITEM #	1-5	6+	ITEM #	1-5	6+	ITEM #	1-5	6+	ITEM #	1-5	6+
IHD6	6"	.42	360271	\$135	\$129	360276	\$140	\$133	360335	\$140	\$133	360281	\$140	\$133	360286	\$140	\$133
IHD7	7"	.46	360272	129	122	360277	124	119	360336	124	119	360282	124	119	360287	124	119
IHD8	8"	.60	360273	120	118	360278	132	128	360337	132	128	360283	132	128	360288	132	128
IHD10	10"	.72	360274	134	128	360279	148	140	360338	148	140	360284	148	140	360289	148	140
IHD12	12"	.76	360275	148	140	360280	162	154	360339	162	154	360285	162	154	360290	162	154



Bend in Locking Tab

### LOCK & KEYS FOR INTERNAL HALYARD DOORS

This lock is suited for any of the doors listed above.

MODEL	ITEM #	DESCRIPTION	1-5	6+	LBS.
IHCL	360291	LOCK w/2 KEYS	\$14.50	\$13.50	.14
IHDK	360292	KEY ONLY	6.40	6.10	.04

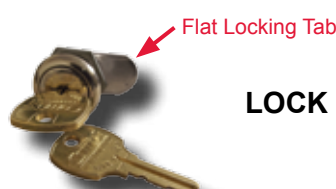

Flat Locking Tab

### LOCK & KEYS FOR DOOR & FRAME UNIT

MODEL	ITEM #	DESCRIPTION	1-5	6+	LBS.
DFL	360303	LOCK w/2 KEYS	\$14.50	\$13.50	.14
DFK	360304	KEY ONLY	6.40	6.10	.04



## INTERNAL HALYARD DOOR & FRAME UNITS

This unit is designed for 5" diameter poles and is used with rope style internal halyard systems. Each unit consists of a hinged door mounted to the front of the frame and a cam cleat (optional) mounted to the back of the frame. The entire unit is inserted into the flagpole shaft and secured with eight 1/4"-20NC stainless steel screws. Minimum hole opening 5 1/2" x 3 1/4". Lock & keys included. Standard stock colors are Silver, Bronze #313, White, Black and painted to match Clear Anodizing. Please specify color when ordering. If not specified Silver will be supplied.

DESCRIPTION	LBS.	SILVER			CLEAR			BRONZE #313			WHITE			BLACK		
		ITEM #	1-5	6+	ITEM #	1-5	6+	ITEM #	1-5	6+	ITEM #	1-5	6+	ITEM #	1-5	6+
WITH CAM CLEAT	3.0	360293	\$144	\$129	360295	\$155	\$141	360297	\$155	\$141	360299	\$155	\$141	360301	\$155	\$141
NO CAM CLEAT	2.8	360294	114	105	360296	126	114	360298	126	114	360300	126	114	360302	126	114



For 25' Thru 39' Poles

For 50' Thru 78' Poles

With Lock & Keys

## DOORS FOR FIBERGLASS INTERNAL HALYARD POLES

MODEL	ITEM #	FOR POLE MODEL #	COLOR	1-5	6+	LBS.
FIHD-1	360305	FG25IH, FG30IH, FG35IH, FG39IH	WHITE	\$93	\$84	.38
FIHD-3	360307	FG50IH, FG60IH, FG70IH, FG78IH	WHITE	204	189	.38



For 50' Thru 78' Poles

## DOOR LOCKS & KEYS FOR FIBERGLASS INTERNAL HALYARD POLES

MODEL	ITEM #	FOR POLE MODEL #	1-5	6+	LBS.
FGL-1	360309	LOCK w/2 KEYS FG25IH, FG30IH, FG35IH, FG39IH	\$14.50	\$13.50	.38
FGK-1	360310	KEY ONLY FG25IH, FG30IH, FG35IH, FG39IH	6.00	5.40	.90
FGL-2	360311	LOCK w/2 KEYS FG50IH, FG60IH, FG70IH, FG78IH	14.50	13.50	.38
FGK-2	360312	KEY ONLY FG50IH, FG60IH, FG70IH, FG78IH	6.00	5.40	.90

All bronze colored accessories on pages 162 through 186 are supplied in a dark bronze #313 shade. If medium bronze #312, light bronze #311 or a custom color is desired, please call for pricing.

# INTERNAL HALYARD PARTS & ACCESSORIES

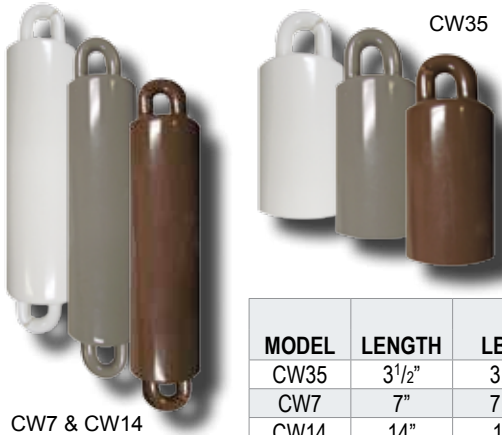

CW7 & CW14

CW35

## COUNTERWEIGHTS

Fabricated from 2" diameter steel and then coated with plastisol. The 3 1/2" pound weights are supplied with one eyebolt attached to one end while the 7 pound and 14 pound weights are supplied with an eyebolt attached to each end.

Counterweights can be mixed to achieve the higher quantity pricing.

MODEL	LENGTH	LBS.	WHITE			SILVER			BRONZE #313		
			ITEM #	1-5	6+	ITEM #	1-5	6+	ITEM #	1-5	6+
CW35	3 1/2"	3.5	360313	\$36.00	\$30.00	360316	\$36.00	\$30.00	360319	\$36.00	\$30.00
CW7	7"	7.0	360314	49.00	44.00	360317	49.00	44.00	360320	49.00	44.00
CW14	14"	14	360315	61.00	55.00	360318	61.00	55.00	360321	61.00	55.00



## CABLE & ROPE CRIMPS

MODEL	ITEM #	FOR CABLE OR ROPE DIA.	MATERIAL			LBS.
				1-5	6+	
CC3	360328	3/32"	COPPER	\$0.70	\$0.60	.01
CC1	360324	1/8"	COPPER	0.70	0.60	.02
CC2	360325	5/32"	COPPER	1.90	1.80	.02
ARC1	360326	1/4" - 5/16"	ALUMINUM	1.70	1.60	.02



## CABLE & ROPE THIMBLES

IHTH-3 & IHTH-1 are Stainless Steel  
IHTH-2 is Zinc Plated Steel

MODEL	ITEM #	FOR CABLE OR ROPE DIA.			LBS.
			1-5	6+	
IHTH-3	360331	3/32"	\$2.50	\$2.30	.02
IHTH-1	360322	1/8" - 5/32"	2.60	2.40	.02
IHTH-2	300238	1/8" - 5/32"	1.10	0.90	.02



## QUICK LINK

Stainless Steel

MODEL	ITEM #	LENGTH	WIDTH	1-5	6+	LBS.
SSQL	360329	2 7/8"	1 3/8"	\$9.60	\$7.10	.20

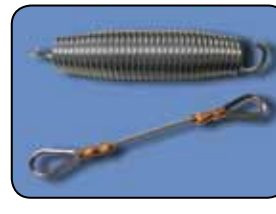

## SHOCK SPRING & SAFETY CABLE

Flagpoles which are utilizing an 8' x 12' flag arrangement or larger it is recommended that a shock spring and safety cable be used. The spring is zinc plated high carbon steel having an overall length of 5 1/2" with the coiled section measuring 4". The 9" safety cable is constructed of 1/8" stainless steel aircraft cable with a stainless steel thimble attached at each end with 2 copper crimps.

MODEL	ITEM #	DESCRIPTION	1-5	6+	LBS.
IHSS	360092	SHOCK SPRING	\$11.30	\$10.10	.04
SCO	360093	SAFETY CABLE	7.50	6.70	.02



## COPPER CABLE STOP

MODEL	ITEM #	FOR CABLE DIAMETER	1-5	6+	LBS.
CS1	360327	1/8"	\$0.70	\$0.60	.01



## STAINLESS STEEL CABLE

Priced Per Foot

MODEL	ITEM #	DIAMETER	1'-199'	200'+	LBS.
SSC32	360330	3/32"	\$1.60	\$1.40	.10
SSC18	360094	1/8"	1.60	1.40	.10
SSC316	360095	3/16"	1.80	1.60	.10



## CABLE SWIVEL CONNECTOR

Stainless Steel

MODEL	ITEM #	LENGTH	WIDTH	1-5	6+	LBS.
IHCSC	360323	2 3/4"	1 1/16"	\$5.70	\$5.30	.20
---	360472	3 1/4"	1 7/16"	11.30	10.80	.28

All bronze colored accessories on pages 162 through 186 are supplied in a dark bronze #313 shade. If medium bronze #312, light bronze #311 or a custom color is desired, please call for pricing.